



COMMUNITY ASSOCIATION

Architectural Control Committee Plan and Specification Review Determination PATIO, DECK, A/C, HOT TUB APPLICATION

(page 1 of 3)

ACC approval includes aesthetic features only and does not imply or warrant any structural integrity. This approval is not based on an engineering review of the site plan or structure. Please note: You may need the City of Mill Creek's permit and/or approval (425) 551-7254.

For MCCA Use Only

Submittal Number

16597

Date Submitted

5/18/22

Please Attach
Color Samples
Here

Applications without
samples will not be
accepted.

Property owners
are responsible
for determining
all property lines,
locations, and
related
easements

Applicant Information

Name **Joseph Hebert**

Ph. **425-318-5736**

Email **joejhebert@hotmail.com**

Site Information

Address **1711 163rd Pl SE, Mill Creek**

Division **Amberleigh**

Lot # **41**

Type of Structure

Patio ☐ Deck ☐ **Heat Pump** Hot tub ☐

Est. Start Date: **6/18/22**

Est. End Date: **6/19/22**

You must attach a diagram, picture, or brochure of the proposed unit and show the exact location of the unit relative to your home and property lines.

Pursuant to the provision of Article VIII, paragraphs 8.1, 8.2, 8.2.1, 8.2.2, 8.2.3, 8.3, 8.3.1, 8.3.2, and 8.3.3 and Article IX of the Mill Creek Declaration of Covenants, the following determination by the Architectural Control Committee is hereby granted:

Approval subject to the following changes:

UNIT MUST BE ENCLOSED WITH 4' HIGH FENCE, BOARDS SPACED TO ALLOW AIR CIRCULATION.

Rejected for the following reasons:

(☒) Approve (☐) Reject

[Signature]
Condominiums & Townhomes ACC or Board Approval

Date: **05/18/22**

(☒) Approve (☐) Reject

[Signature]
MCCA Administration

Date: **5/19/22**

(☒) Approve (☐) Reject

[Signature]
Chair, Architectural Control Committee

Date: **5/18/22**

(☐) Approve (☐) Reject

Date: _____

(☐) Approve (☐) Reject

Date: _____

(☐) Approve (☐) Reject

Date: _____

Application may be
mailed, emailed
(info@mcca.info), or
dropped off at the MCCA
Office (15524 Country
Club Dr, Mill Creek, WA
98012)

2 3 3 3

MUST BE ENCLOSED
WITH 4' HIGH FENCE,
BOARDS SPACED TO PERMIT
AIR CIRCULATION

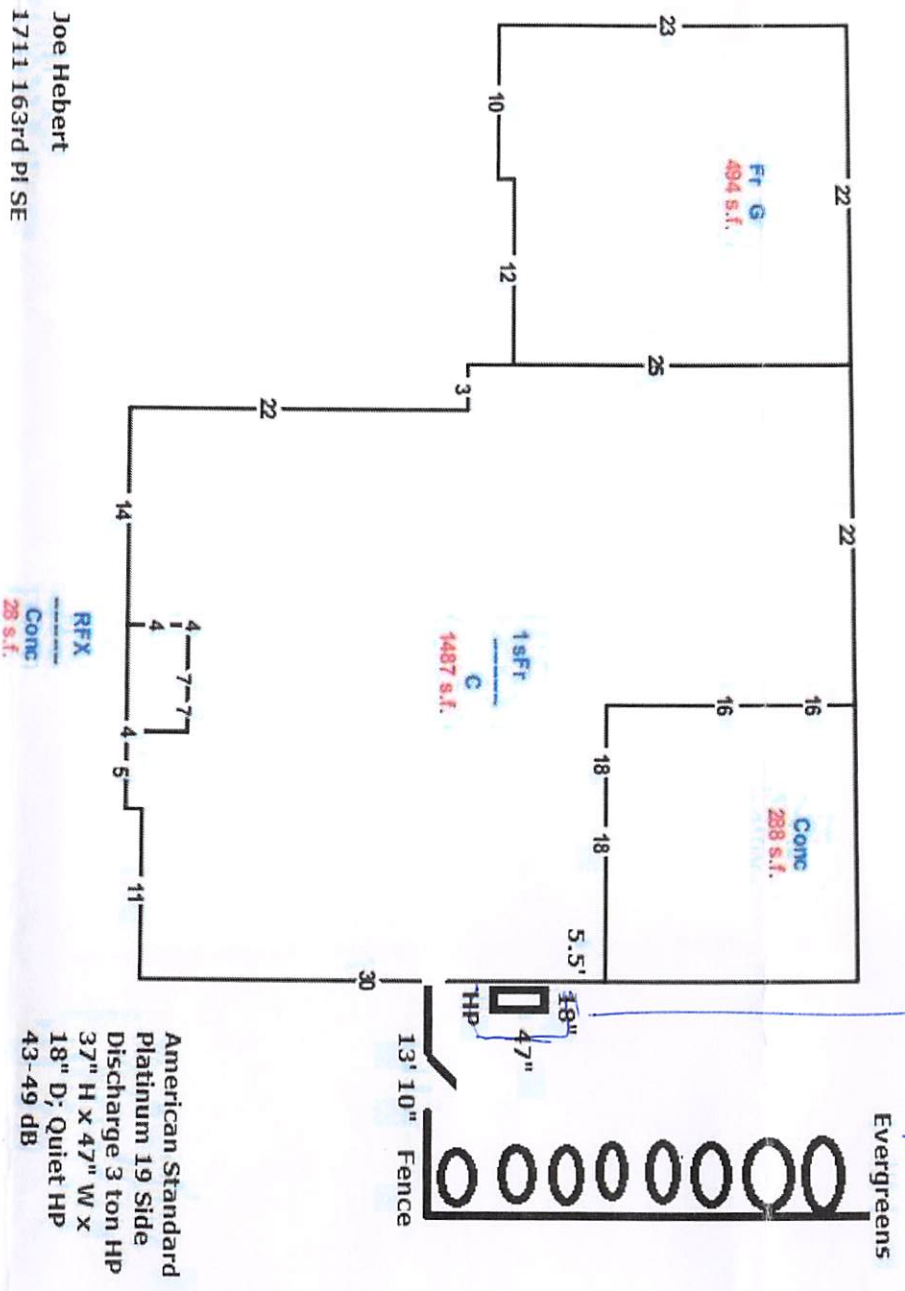

Joe Hebert
1711 163rd Pl SE